

| | | Sloane Suite | Brompton Room | Beauchamp Room | Cadogan Suite | Knightsbridge Room | Chelsea Room |
|-------------|---------------------|--------------|---------------|----------------|---------------|--------------------|--------------|
| Dimensions | Floor | 2 | 2 | 2 | 2 | 2 | 2 |
| | Length | 14.70 | 9.60 | 5.00 | 12.00 | 6.40 | 5.50 |
| | Width | 8.90 | 8.90 | 8.90 | 4.80 | 4.80 | 4.80 |
| | Height | 2.90 | 2.90 | 2.90 | 2.20 | 2.20 | 2.20 |
| | Area M ² | 130.83 | 85.44 | 44.50 | 57.80 | 30.72 | 26.40 |
| Room style | Cabaret | 54 | 36 | 18 | 24 | 18 | - |
| | Theatre | 120 | 80 | 34 | 60 | 35 | 24 |
| | Classroom | 80 | 50 | 22 | 42 | 18 | 12 |
| | U-shape | 48 | 28 | 20 | 30 | 15 | 8 |
| | Boardroom/Hollow sq | 50 | 30 | 24 | 32 | 16 | 12 |
| | Lunch/Dinner | 100 | 60 | 30 | 40 | 20 | 10 |
| Environment | Natural light | • | • | • | • | • | • |
| | Blackout | • | • | • | • | • | • |
| | Air-conditioning | • | • | • | • | • | • |

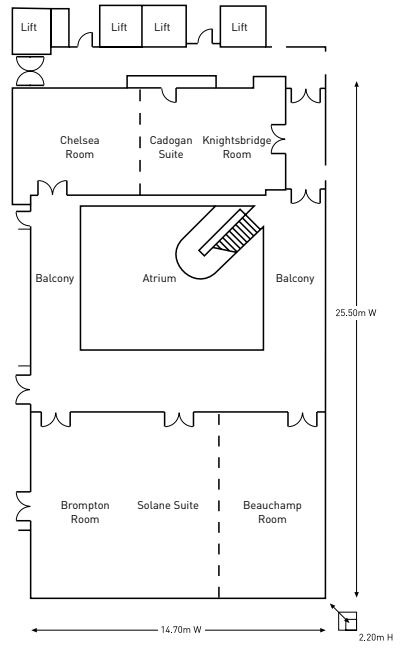

| | | MU | MU Restaurant | MU Bar | Snug |
|-------------|---------------------|-------|---------------|--------|------|
| Dimensions | Floor | 2 | 2 | 2 | 2 |
| | Length | 13.00 | 7.00 | 3.00 | 2.00 |
| | Width | 7.30 | 7.30 | 7.30 | 2.00 |
| | Height | 2.50 | 2.50 | 2.50 | 2.50 |
| | Area M ² | 94.90 | 51.10 | 21.90 | 4.00 |
| Room style | Reception | 250 | 200 | 80 | 20 |
| | Lunch/Dinner | - | 120 | - | - |
| Environment | Natural light | • | • | • | • |
| | Air-conditioning | • | • | • | • |

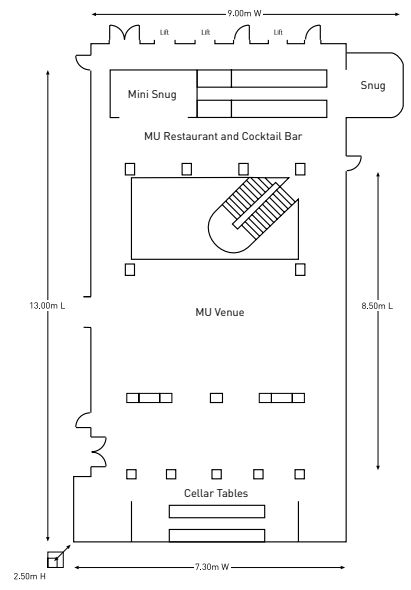



MU VENUE

Floor plans and dimensions